

Lancashire County Council

Regulatory Committee

Wednesday, 27th September, 2023 at 10.30 am in Committee Room 'D' - The Henry Bolingbroke Room, County Hall, Preston

Supplementary Agenda

We are now able to enclose, for consideration at the next meeting of the Regulatory Committee to be held on Wednesday, 27th September, 2023, the following information which was unavailable when the agenda was despatched

Part I (Open to Press and Public)

No. Item

- 6. Wildlife and Countryside Act 1981 (Pages 1 - 4)**
Definitive Map Modification Order Investigation
Bridleway along Long Lane, Hoghton, Chorley

H MacAndrew
Director of Law and Governance

County Hall
Preston



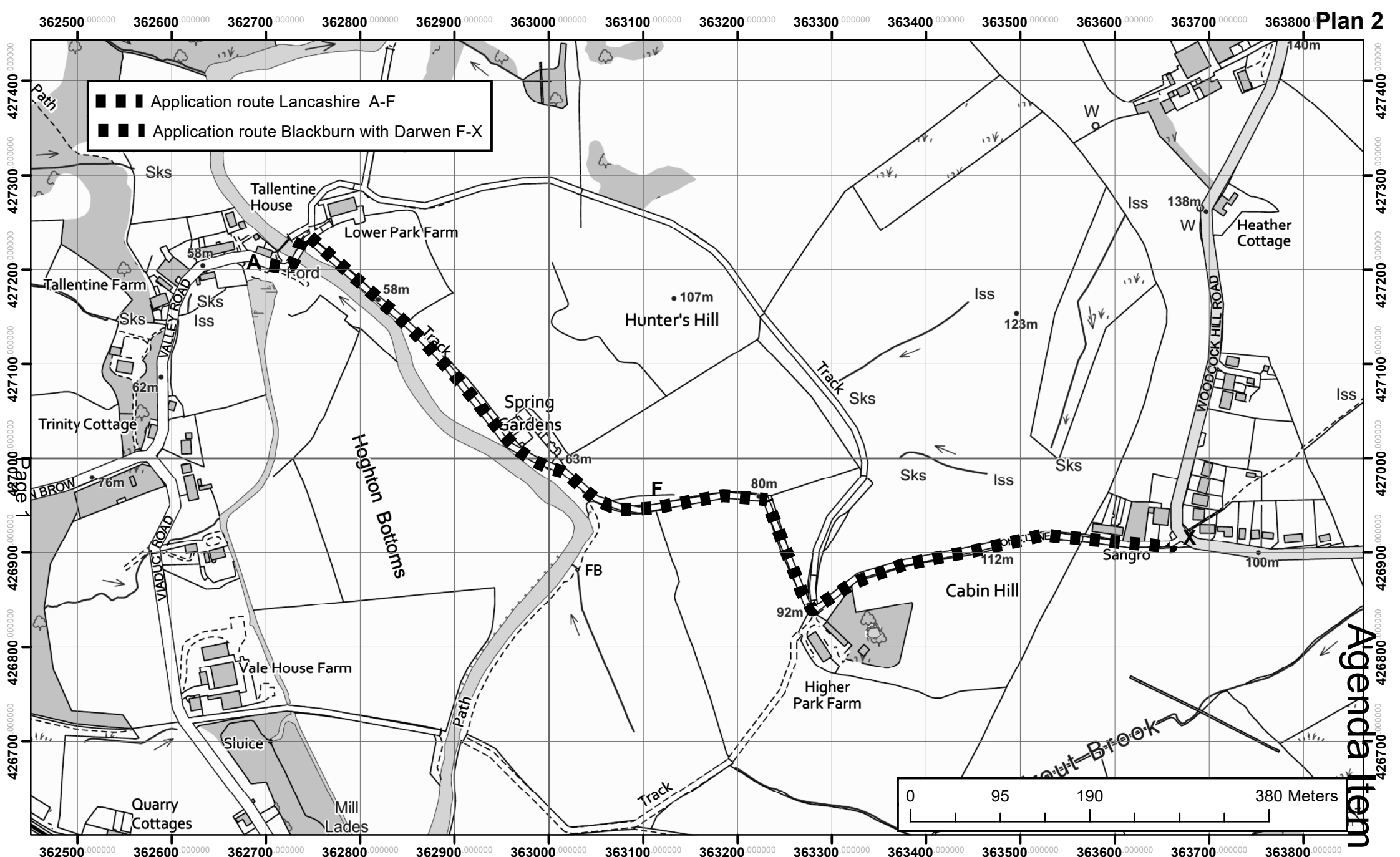

Agenda Item 6

Lancashire
County Council

Public Rights of Way
PROW@lancashire.gov.uk
01772 530317

Wildlife and Countryside Act 1981
Addition of Bridleway and upgrading of Footpath to Bridleway along Long Lane, Hoghton

1:5,000

The digitised Rights of Way information should be used for guidance only as its accuracy cannot be guaranteed. Rights of Way information must be verified on the current Definitive Map before being supplied or used for any purpose.

This Map is reproduced from Ordnance Survey material with the permission of Ordnance Survey on behalf of the controller of Her Majesty's Stationery Office (C) Crown Copyright. Unauthorised reproduction infringes Crown Copyright and may lead to Prosecution or civil proceedings. Lancashire County Council Licence No. 100023320

362700.000000

362800.000000

- ■ ■ Route under investigation A-Z
- - - Public Footpaths

427300.000000

427300.000000

427200.000000

427200.000000

427100.000000

427100.000000

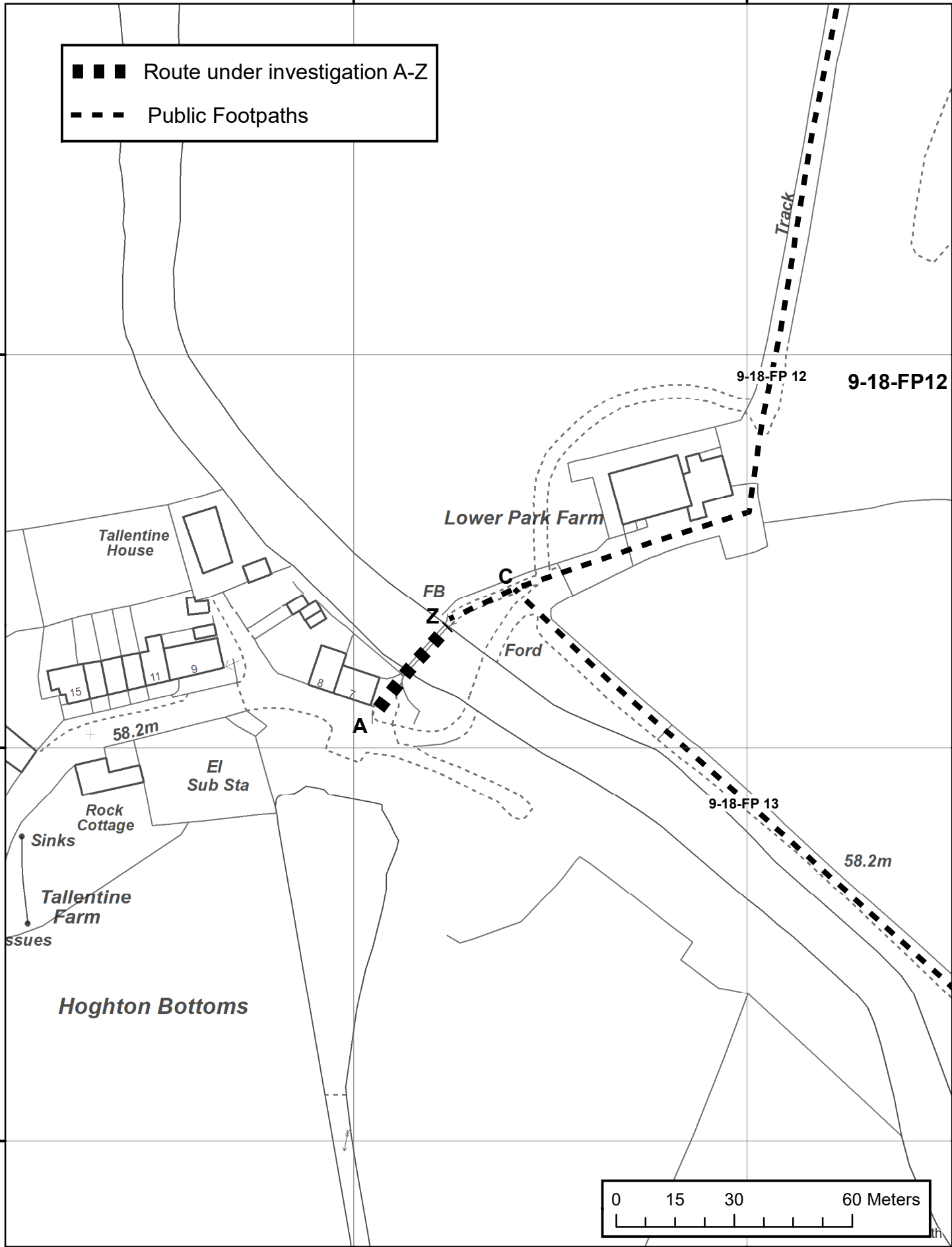

362700.000000

362800.000000



